

SAF bearing housings

SKF SAF housings have a stiff and robust design and are accurately machined to protect and support the bearings contained in them. Combining minimal deflection under load with good lubricant retention and high resistance to the ingress of contaminants, these housings optimize the performance and extend the service life of the bearing, while reducing maintenance cost and associated downtime. SAF bearing housings are available for shaft diameters ranging from 1 ³/₁₆ to 10 ⁷/₁₆ inches.

Product features

- Stiff and robust design made of high grade grey cast iron
- High load carrying capacity
- Accommodates spherical roller bearings (including series 232), self-aligning ball bearings and CARB toroidal roller bearings, as either a locating or non-locating bearing
- Markings on the base indicate the center of the bearing seat and the axis of the housing bore
- Cast dimples indicate locations on the cap to drill and tap for condition monitoring devices or for additional seal lubrication, and on the base to drill for dowel pins, if required
- Standard seal groove to which all seal options fit
- Grease guiding system for housing sizes 507 to 544 delivers grease to the side of the bearing efficiently
- Grease level indicator on most housings

User benefits

- Optimizes bearing performance and extends service life
- Low maintenance costs
- Reliable housing performance
- Same housing accommodates bearing as either locating or non-locating
- Good heat dissipation results in lower operating temperatures
- Accurate alignment and simplified mounting
- Easy to locate positions for attaching condition monitoring equipment or adding seal re-lubrication, if required
- Seal type available for virtually any application
- Fast, easy and accurate seal mounting
- Easy and more efficient relubrication

Common applications

- Fans
- Conveyors
- Mills
- Crushers
- Rotary kilns

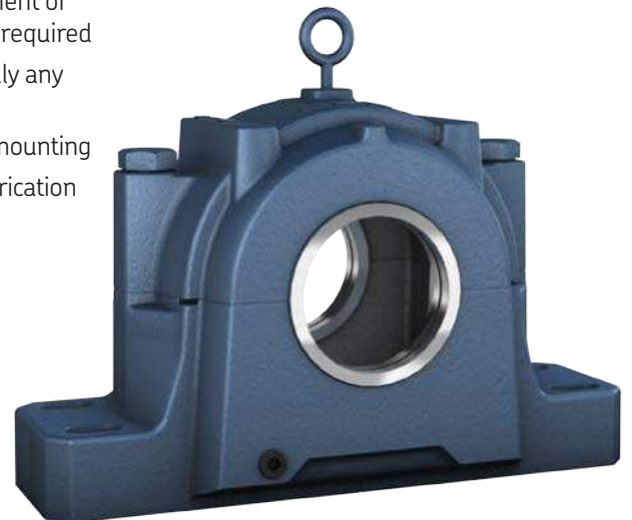

Industry leading performance

High machining quality

Tight housing bore tolerances reduce operating temperatures to extend the service life of the bearing and lubricant.

High strength material

High grade cast iron accommodates heavy loads. For applications where extra strength is needed, SAF housings are also available in cast steel, designation SAFS or spheroidal graphite cast iron (ductile iron), designation SAFD.

Simple, accurate mounting

Housing bases and caps are not interchangeable. To avoid mismatch and provide traceability, both the base and cap of each set is marked with a unique number (→ **fig. 1**). Easy alignment. Centre-line marks are cast in housing base (→ **fig. 2**).

Excellent heat conduction

An extra reinforcement in the middle of the housing (→ **fig. 3**) improves heat dissipation to support surfaces.

Sold as a kit

SAF housings are typically supplied as a complete kit (→ **fig. 4**), including housing, seals, bearing, adapter sleeve (or nut and washer) and a locating (stabilizing) ring.

Housing bore tolerance deviation

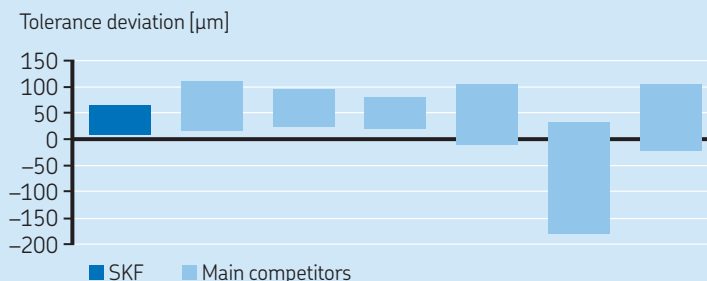

Fig. 1

Individually marked cap and base

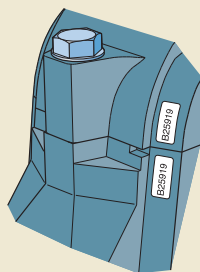

Fig. 2

Simple and accurate mounting

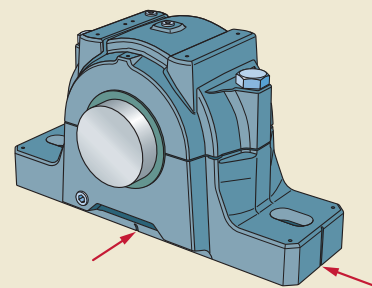

Fig. 3

Excellent heat conduction

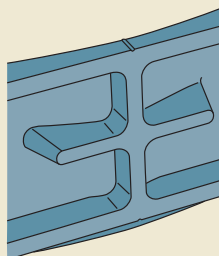
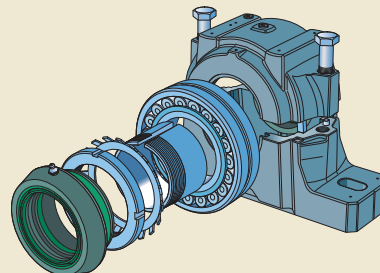

Fig. 4

SAFD 23520 LOR



Sealing options

Range of different sealing arrangements available



Labyrinth seal
LER



PosiTrack seal
LOR



PosiTrack Plus
seal



Taconite seal
TER



Taconite seal
TER-V.... with v-ring



Contact seal



End plug

skf.com

© SKF is a registered trademark of the SKF Group.

© SKF Group 2015

The contents of this publication are the copyright of the publisher and may not be reproduced (even extracts) unless prior written permission is granted. Every care has been taken to ensure the accuracy of the information contained in this publication but no liability can be accepted for any loss or damage whether direct, indirect or consequential arising out of the use of the information contained herein.

PUB BU/S7 15496 EN · July 2015

SKF